



About St Wilfrid's

This charming 13th-century building was formerly the chancel of the much larger St Peter's church which, in 1864, was removed stone by stone and rebuilt further south in the new town of Selsey. After its removal the remaining chancel was closed and used as a mortuary chapel. St Wilfrid's was granted chapel status by Bishop Ridgeway in 1917.

It is located on or very close to the site of the first Cathedral of Sussex which was established by St Wilfrid when he came to live on this spot for a period of six years from AD 681. The Diocese was organised from here until 1075 when the Bishop moved his throne (cathedra) to Chichester. Thereafter a church survived here to minister to the needs of the local population who had established themselves under the church's protection.

Although the current building does not date from the period of St Wilfrid it contains features of considerable interest, including notable 20th-century stained glass, together with fittings and memorials from earlier centuries. It is still used for occasional services and is cared for by many local people including the Friends of St Wilfrid's Chapel who work with The Churches Conservation Trust, to whom the care of the chapel was entrusted in 1990.

A thousand years of English history awaits you

The Churches Conservation Trust is the national charity protecting historic churches at risk.

We've saved over 340 beautiful buildings which attract almost 2 million visitors a year.

With our help and with your support they are kept open and in use – living once again at the heart of their communities.



Access

Due to their age, historic church floors can be uneven and worn, and lighting can be low level. Please take care, especially in wet weather when floors can be slippery.

Help us do more

We need your help to protect and conserve our churches so please give generously. To become a CCT Supporter please pick up a leaflet or go to our website.



THE CHURCHES
CONSERVATION TRUST

visitchurches.org.uk

The Churches Conservation Trust
Society Building, 8 All Saints Street, London N1 9RL Tel 0845 303 2760



[facebook.com/ChurchesConservationTrust](https://www.facebook.com/ChurchesConservationTrust)



[twitter.com/The CCT](https://twitter.com/The_CCT)

Registered Charity No: 258612

50p

© CCT 2013

your church tour

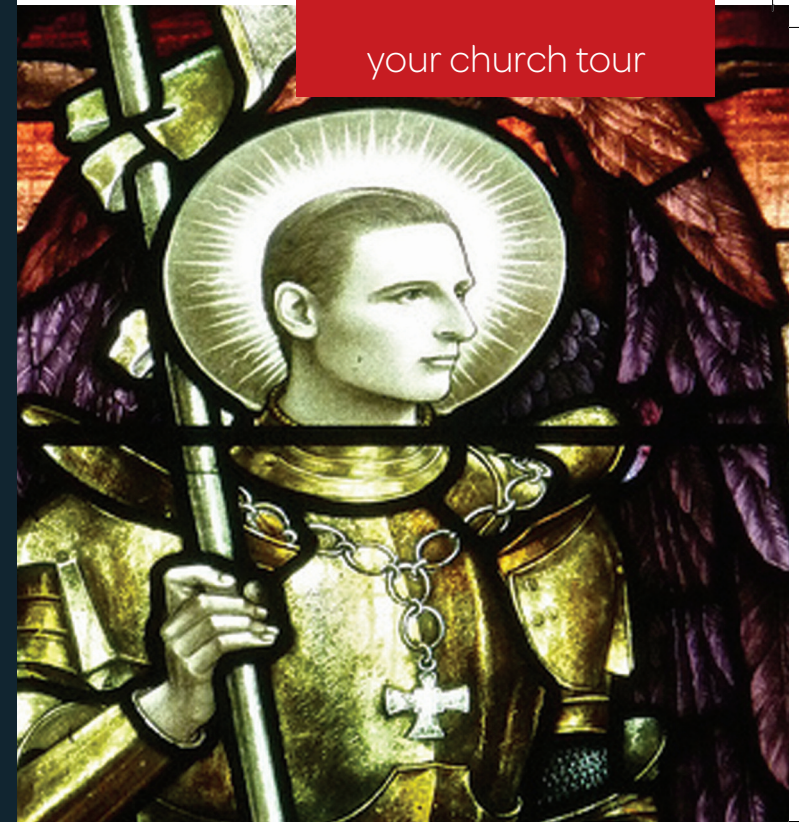

Chapel of St Wilfrid

Church Norton, Sussex



THE CHURCHES
CONSERVATION TRUST

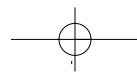

FOLD

1 The Victorian **font** is believed to have come from the redundant church of St Martin's, Chichester, along with 12 oak benches. The former square late Saxon or early Norman Purbeck marble font, currently in St Peter's, Selsey, is reputed to have come from the former Cathedral at Norton.



2 Worn Sussex marble **coffin slabs** in the floor have inscribed crosses, one of which (in the vestry) was taken for the symbol of the Friends of St Wilfrid's Chapel.

3 A **tablet** commemorates William Clayton who died aged 18 on the island of Lombok in Indonesia in 1835.



4 Stained glass **window** in memory of Vera Buxton-Knight who, although born in England, gained her nursing qualification while in Canada and spent her winters with her husband in Cairo where she was involved in charitable work, as she was in Selsey with the ARP and St John's Ambulance. It was designed by Carl Edwards in 1973.

5 Stained glass **window** in memory of Reginald Charles Chaplin dedicated in 1982. Charles' great love of nature and the wildlife around Norton is reflected in this window. It is signed by Michael Farrar Bell.



6 The **Tudor monument to John Lewis**, of Caen stone from northern France, depicts John and his wife Agatha. John was Lord of the Manor when it was annexed by Queen Elizabeth in 1561. Both John and Agatha can be seen kneeling opposite each other at carved kneeling benches – *'prie-dieus'* – in what is considered a position of piety, a popular feature in Tudor times. Behind them on each side, in bas-relief, are St George and St Agatha.

7 Squares cut out of the plaster of the walls relate to **wall paintings** discovered in January 1996. It is very difficult to make out what the main paintings portray but five locations were identified within the chapel.

8 The great **east window** was commissioned in 1918 by Maurice Wingfield and depicts three main characters – John Wingfield, brother to Maurice, who died in the First World

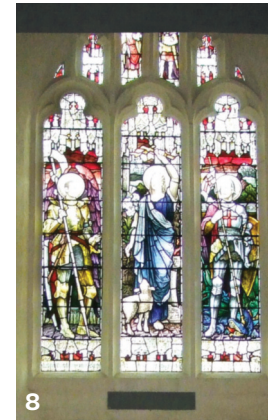

representation of St Wilfrid, holding a depiction of his church at Selsey, on the left and King Ethelwald (Æthelwealh), who gave Wilfrid the land for the church, on the right. The window was produced by Heaton, Butler and Bayne.

9 The present 20th-century **altar** consists of a floating shelf of massangis stone, quarried in France. It was designed by E O Purser and produced and fitted by the Cathedral Works Organisation. The children of former parishioners John and Mary Munton arranged for this work in memory of their parents and it was dedicated by Bishop Warren Hunt in 1988.



10 The vibrant **altar cloth**, inspired by the stained glass, was designed and donated to the Friends of St Wilfrid's by the Selsey Quilters during the summer of 2008. Look out for the logos of The Churches Conservation Trust and the Friends of St Wilfrid's Chapel.

11 The combined **credence table** and **piscina** of Caen stone, is located in the conventional position on the southern wall of the chancel towards the corner near the altar.



12 Stained glass **window** dedicated in 1962 and commemorating Freda Yelf who died in 1960. It depicts St Wilfrid and St Luke; the latter holds a representation of the Aesculapian staff.

13 The **Moir Mackenzie window**, dedicated by Lady Mackenzie to her husband in 1964, depicts scenes from St Wilfrid's life, including the well-known legend that he taught the men of Sussex how to fish with a net. Sir Moir was formerly Vice President of the Federation of British Industry (now the CBI) and President of the Scottish Rugby Football Union.

Both these windows were designed by Christopher Webb who also designed glass in another Churches Conservation Trust church in Sussex, St Andrew, Waterloo Street, Hove.

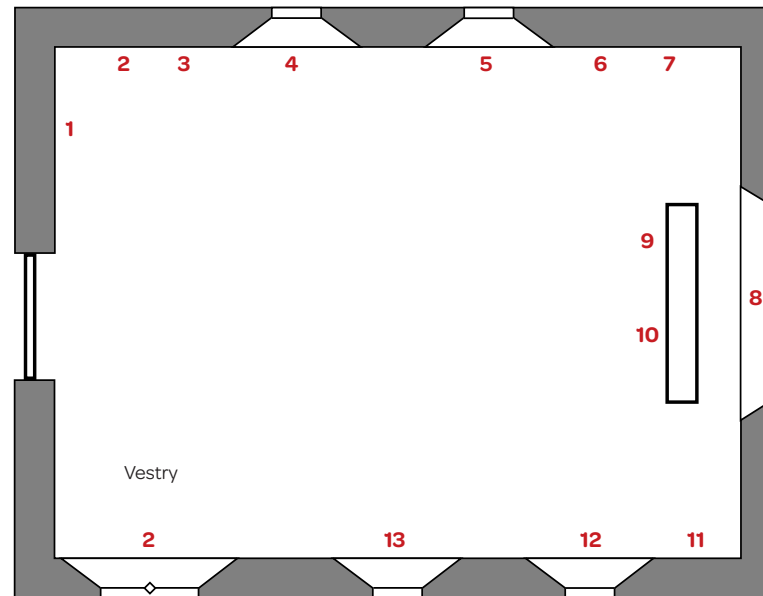

War, his sister-in-law Stephanie Agnes who died in 1918, and Thomas Agar-Roberts (a friend of John) who also died during the Great War. On the left John is depicted in full medieval golden armour as the archangel St Michael (cover); the mauve feathers of the wings can be seen. Stephanie Agnes appears in the centre light with a lamb. *'Agnus Dei'*, the Latin for 'lamb of God', constitutes an alliterative reference to her name in depicting her as St Agnes. The third light shows Thomas, also in full medieval armour, as St George with the lanced dragon at his feet. Above the true likenesses of the individuals is a

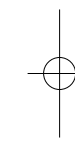
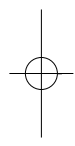

FOLD

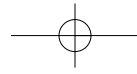

FOLD